

HEIGHTS WITHOUT TOLERANCES ACCORDING TO DIN 7168						
De 0.5a6	De 6a30	De 30a120	De 120a315	De 315a1000	> 1000	
±0.1	±0.2	±0.3	±0.5	±0.8	±1.2	øH12

MODIFICATIONS			
Tip.	DESCRIPTION	DATE	SIGNATURE

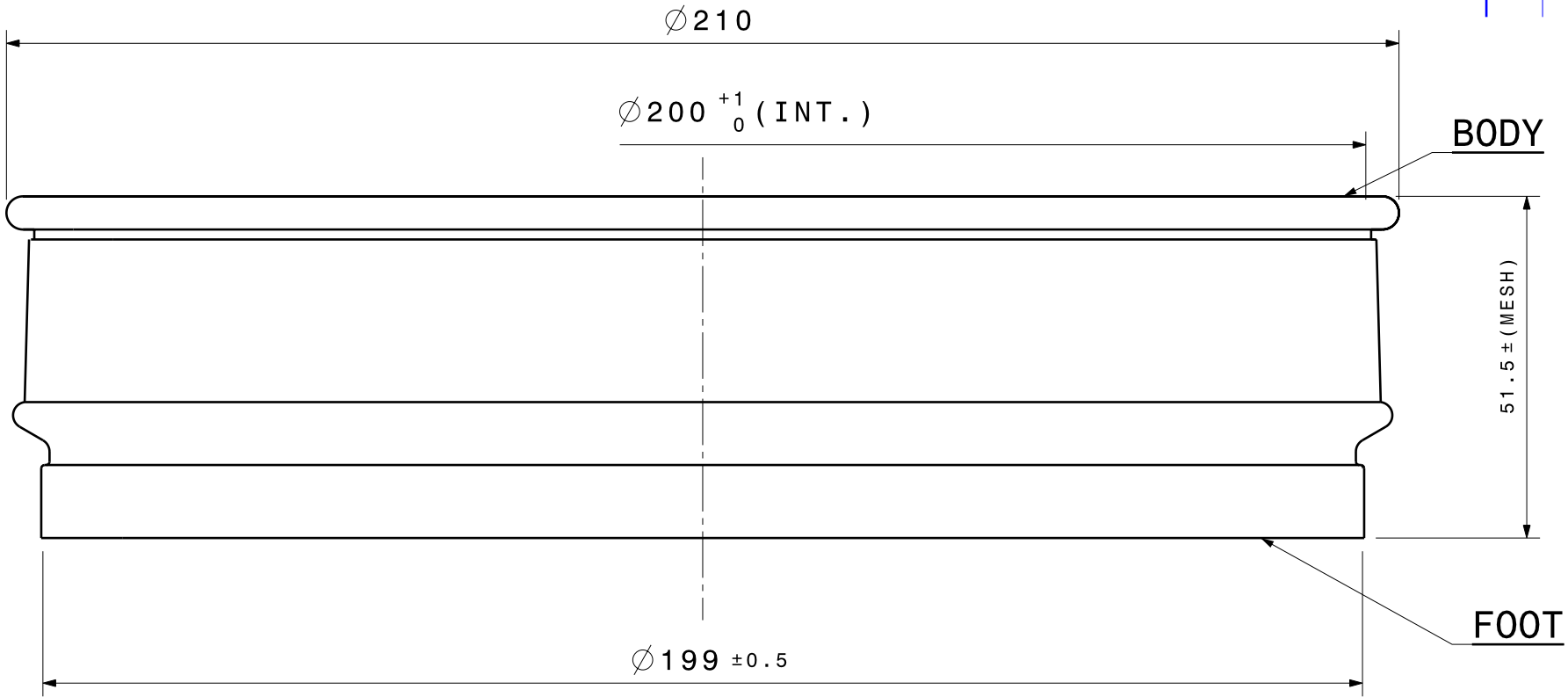

DRAWING PRODUCED BY COMPUTER
DO NOT ALTER MANUALLY

TECHNICAL DEPARTMENT
INTEGRATED QUALITY

SIEVE Ø200M
Scale 1:1

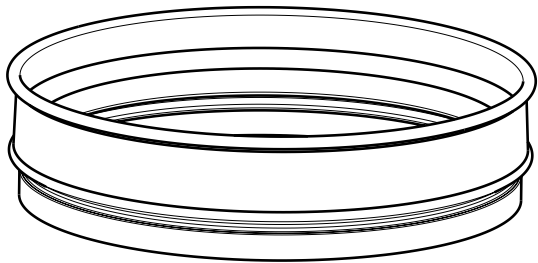

ISOMETRIC VIEW

0200M	FOOT	H03	FOOT-200M		AlSI 304	1	0.8	635	47
0200M	BODY	H02	BODY-200M		AlSI 304	1	0.8	631.3	45.2
0200M	SIEVE	H01	XXXXXXXXXXXX		AlSI 304	1	0.8	XXXX	XXXX
CONJ. N°	PART N°	SHEET	DESIGNATION	MATERIAL	QUANTITY	THICK DIAMETER	WIDTH	LONG	
SCALE			Name	Date	Signature		<div>GRANULOSHOP.COM</div> <div>Nominal Diameter = 200 mm for air aspiration devices</div>		
1:1	DRAWED		MCarvajal	03/01/05	ORIGINAL				
	REVISED		T. JIMENEZ	02/01/07	ORIGINAL				
TITLE: SIEVE INOX Ø200M (Air Jet sieve)									
REFERENCE: SIEVE INOX-200M						N° of sheet		SHEET n°	
						H03		H01	